



**TIBO**

**Plus 1.1 / Plus 2.1 / Plus 3.1**

---

**User Manual**

# Contents

<b>1. Safety Information</b> .....	<b>2</b>
1.1. Installation location .....	3
1.2. Warning .....	3
1.3. Cleaning and maintenance .....	3
1.4. Before moving the appliance .....	3
1.5. Storm .....	3
1.6. Do not drop small items or a liquid into the appliance.....	3
1.7. Repacking the appliance .....	4
1.8. Batteries .....	4
<b>2. First time speaker setup</b> .....	<b>5</b>
2.1. In the box.....	5
2.2. Rear panel layout.....	6
2.3. Remote Control.....	7
2.4. Setting up your speakers .....	8
2.5. Volume/Input Select Knob .....	9
<b>3. Connecting Audio Sources</b> .....	<b>10</b>
3.1. Analogue Inputs / Digital Inputs .....	10
3.2. Connecting a Subwoofer .....	11
<b>4. Bluetooth mode</b> .....	<b>12</b>
<b>5. Line In mode</b> .....	<b>13</b>
<b>6. Troubleshooting</b> .....	<b>14</b>
<b>7. Specifications</b> .....	<b>15</b>

# 1. Safety Information

Do not share the power socket with another appliance

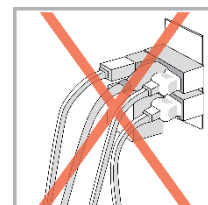

Do not disassemble or attempt to repair the appliance on your own.

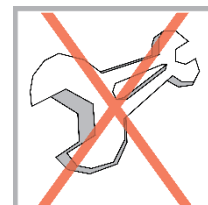

If you are not using the appliance, pull the power cord out of the mains socket.

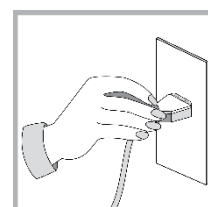

Be careful of the power cord and maintain it as appropriate. To ensure safety, do not twist the power cord, do not pull it out of the socket, do not compress it or stretch its length.

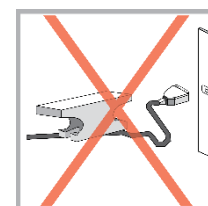

Do not use the appliance if the supply voltage is lower than 90V or higher than 240V. If the supply voltage is lower than 90V, the appliance may not work, and its lifetime may be affected. If the voltage is higher than 240V, the appliance may catch on fire or cause a fire.

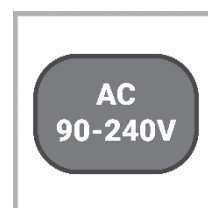

Do not wash the appliance or use it in the bathroom, or it may cause potential injuries and other problems.

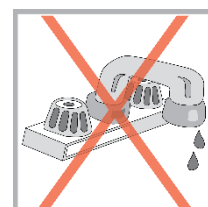

## 1.1. Installation location

Leave sufficient space around the appliance of at least 5 cm from any wall/obstacle to ensure proper ventilation and prevent the appliance from overheating.

The following places are not suitable installation locations for the appliance:

- An unstable location
  - A location near a heat source or in direct sunlight.
  - In a wet or dusty environment
- 

## 1.2. Warning

To prevent suffering an electrical shock or another accident, do not operate the appliance in a rainy or humid environment.

---

## 1.3. Cleaning and maintenance

Use a soft cloth or cotton dipped in a neutral solution for cleaning the surface of appliances. Do not use the type of cloth that you use for washing dishes or aggressive chemical agents.

---

## 1.4. Before moving the appliance

Before moving the appliance to a different location, please take the disc out of the appliance so that the disc and appliance will not be damaged.

---

## 1.5. Storm

If the appliance is not working properly during a storm, please disconnect the plug from the power socket and reinsert it after a minute.

---

## 1.6. Do not drop small items or a liquid into the appliance

In the event that you find small items or a liquid inside the appliance, you see smoke or smell an odour, immediately disconnect the appliance from the power grid. Send the appliance to an authorised service centre.

---

## 1.7. Repacking the appliance

When sending the appliance by a transport company, use the original packaging to prevent its damage during transport.

---

## 1.8. Batteries

When installing the batteries into your remote control, ensure they are inserted correctly according to the diagram. Plus with plus and minus with minus.

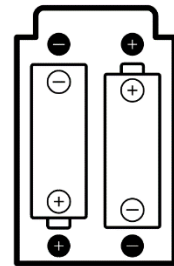

2 x R03 / AAA

---

## 2. First time speaker setup

### 2.1. In the box

- Plus+ Active Speaker x 1
  - Plus+ Passive Speaker x 1
  - Remote Control x 1
  - Speaker Cable x 1
  - 3.5mm to RCA Cable x 1
  - Standard UK plug x 1
  - Standard EU plug x 1
  - User Guide x 1
- 

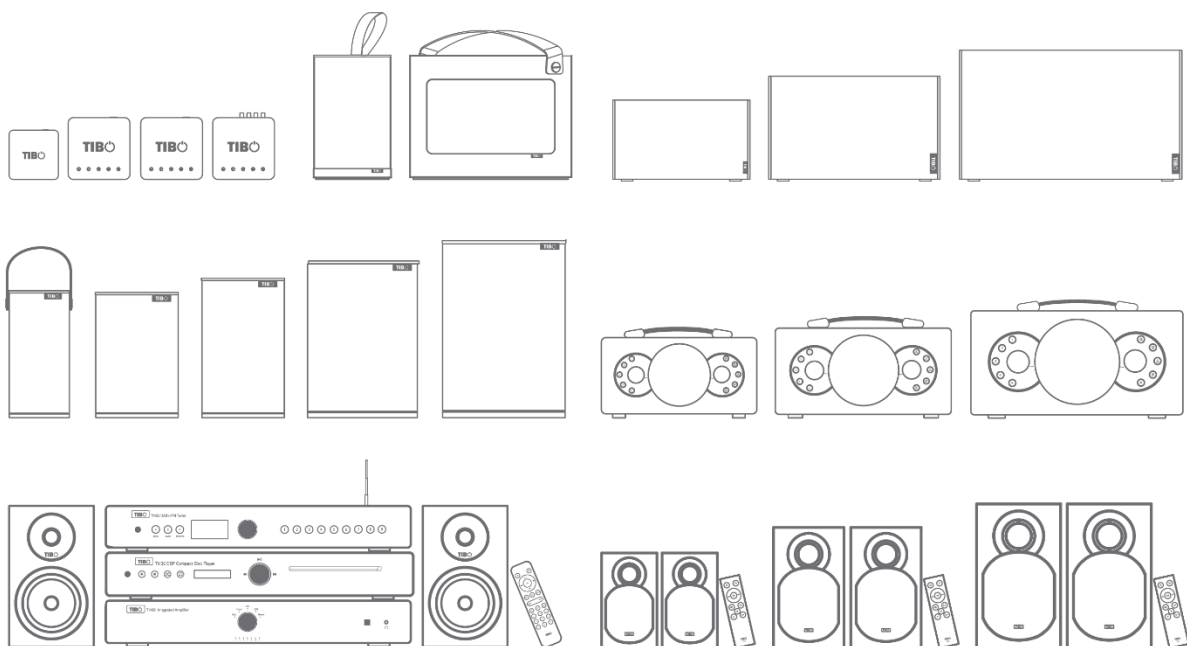

## 2.2. Rear panel layout

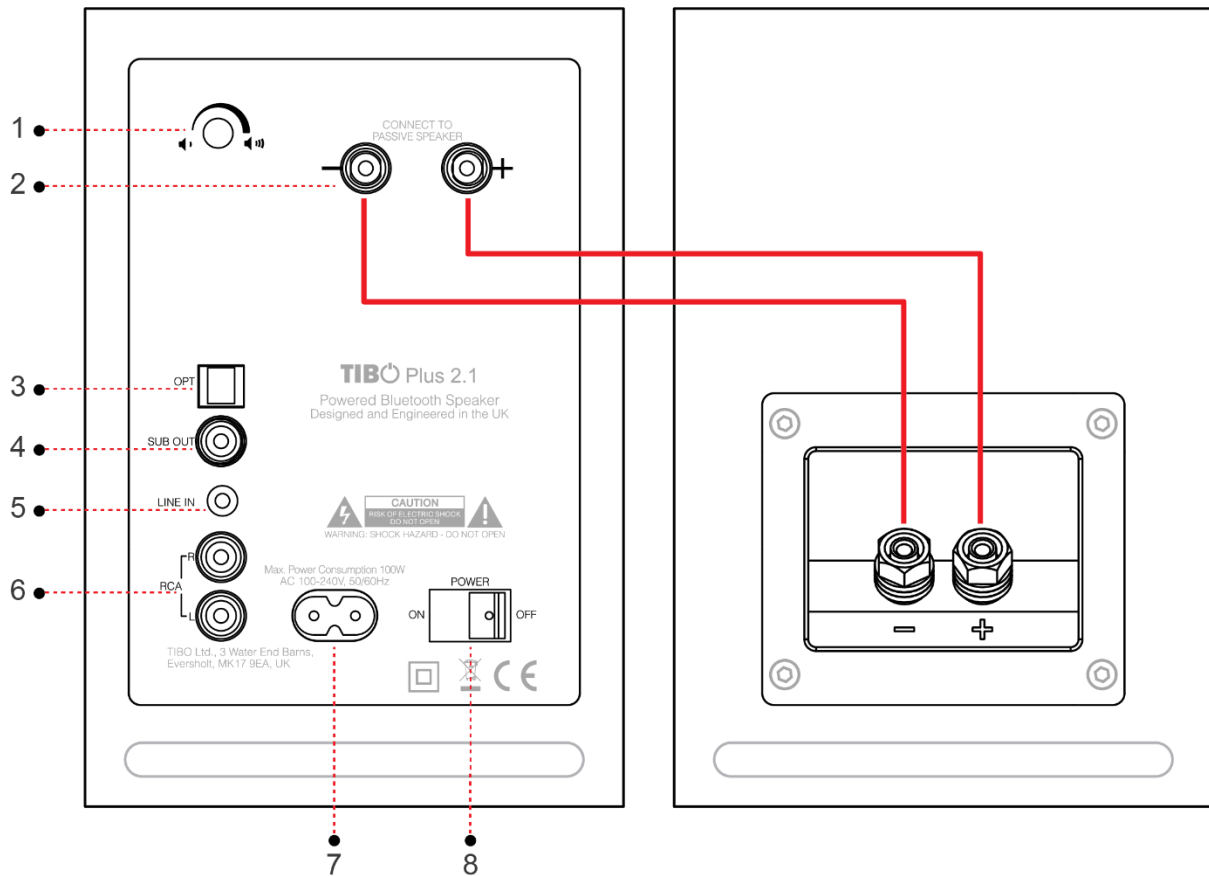

1. Volume and Mode select knob

2. Speaker output binding post to connect to passive speaker

3. Optical output

4. Subwoofer output

5. 3.5 mm Stereo mini-jack AUX input

6. RCA L/R Input

7. AC Input Connection (100 V - 240 V 50/60 Hz)

8. ON / OFF Switch

## 2.3. Remote Control

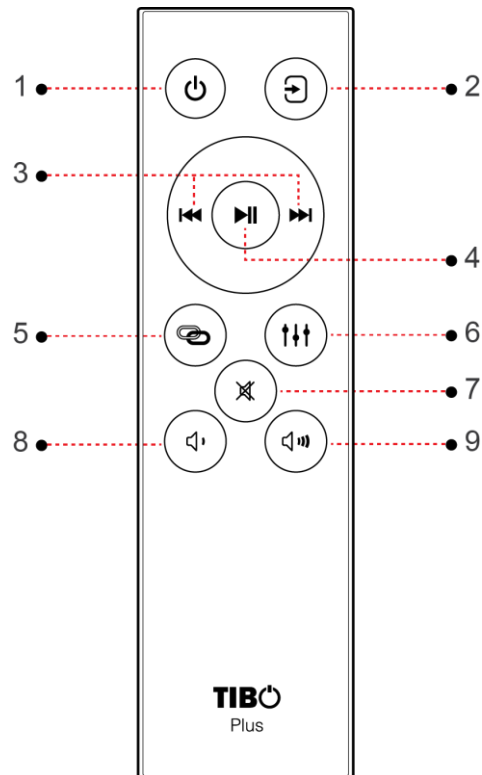

1. Power On / Standby

---

2. Mode Select

---

3. Skip Track Forward / Backward

---

4. Play / Pause

---

5. Pair / Unpair From Bluetooth

---

6. Bass / Treble Adjustment

---

7. Mute Function

---

8. Decrease Volume

---

9. Increase Volume

---



## 2.4. Setting up your speakers

The powered speaker system is designed for either bookshelf or stands mounting. The stands should be of rigid construction, between 45 cm to 69 cm high and preferably have spikes.

The space between the two speakers and the distance from the listener is important. If the speakers are positioned too close or too far apart, stereo imaging will not be fully developed. Speakers are designed to perform optimally positioned at least 20 cm from the rear wall in an average listening room. However, it may not be possible to install the speakers in this position and since rooms vary in shape, size, and furnishing, a certain amount of experimentation is necessary to determine the most suitable position.

Moving the speakers very close to the rear wall will enhance the bass frequencies but will tend to reduce soundstage depth, while moving the speakers away from the rear wall will tend to have the opposite effect. Avoid positioning the speakers close to or in the corners of the room, as this will excite undesirable room coupling in the low and middle frequencies.

If the width of the rear wall is limited, then toe-in the speakers slightly to reduce reflections. Room characteristics and positioning have a profound effect on the performance of the speakers, so time and effort devoted to achieving the optimum positions will be rewarded.

Ensure that the ON/OFF Switch is in the OFF position. Connect the two speakers together as shown below using the supplied speaker cable. Connect the RED (+) and BLACK (-) terminals from the active speaker (left channel) to the corresponding terminals on the passive speaker (right channel).

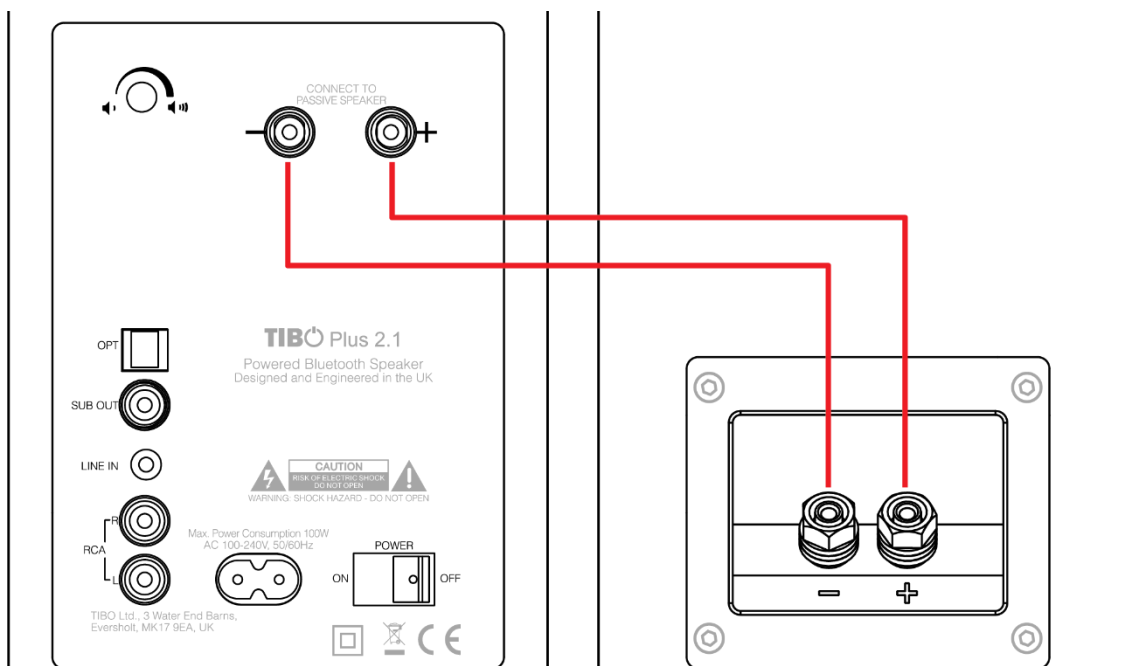

If you wish to place your speakers further apart than the supplied cable will reach, we recommend that you purchase a heavier gauge of speaker cable to minimize signal loss.

Follow the instructions on the ensuing pages to connect your audio sources to speakers. The examples in the following pages are not meant to be exhaustive - just examples. Connect the power cord from active speaker to the wall outlet.

## 2.5. Volume/Input Select Knob

The volume knob on the active speaker functions as an input select knob as well. Push the knob to select an input source, it cycles through the following inputs depending on what input source was last used. RCA, LINE-IN, OPT and BLUETOOTH.

Press and hold volume knob for few seconds to switch Plus system ON of OFF.

**Note:** The Plus speakers feature an auto standby function as this saves power consumption. Auto Wake-Up Off: power consumption < 0.5 W Auto Wake-Up On: power consumption < 3 W

## 3. Connecting Audio Sources

TIBO Plus speakers feature a high-quality DAC (digital-to-analogue converter) that supports data streams up to 24-bit/48 kHz resolution.

TIBO Plus speakers support Bluetooth technology.

Use the appropriate audio cable to connect your audio source components to your speakers. Refer to the following diagrams on connectivity options.

### 3.1. Analogue Inputs / Digital Inputs

The Plus speakers have two options for analogue audio connections.

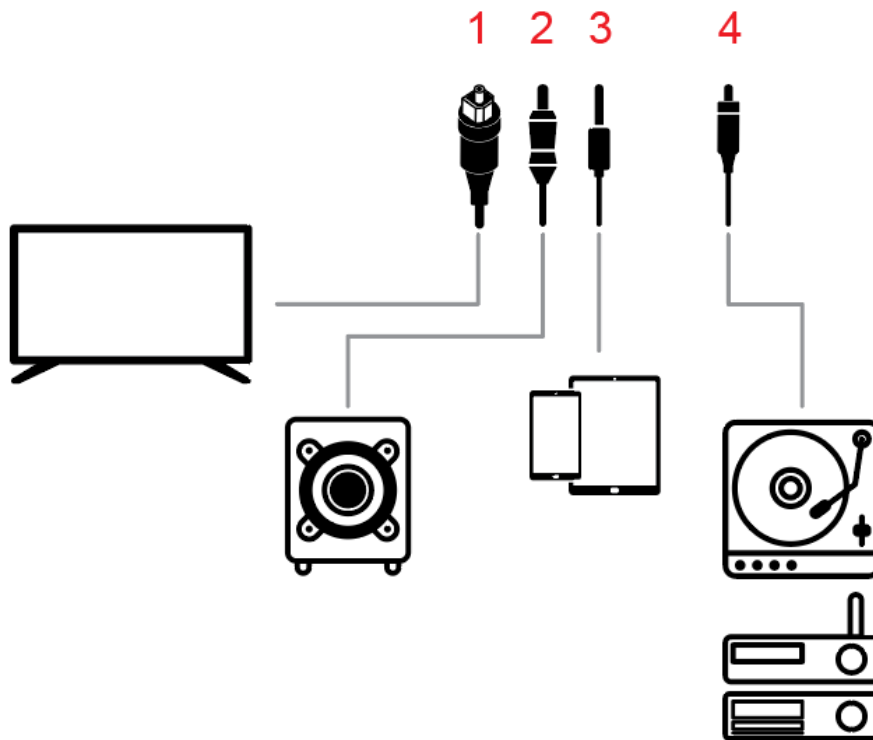

1. Digital Optical Input - TOSLINK® connector for connection to the digital optical output on a TV or other source.
2. 3.5 mm Stereo mini jack - The 3.5mm input jack is ideal for connecting to the headphone output of an external audio source such as a Phone or Tablet.
3. RCA - Connect the RCA L&R audio output from a Turntable, Amplifier or other source to the RCA sockets.

## 3.2. Connecting a Subwoofer

Plus speakers are equipped with an RCA connector to provide output signal to a powered subwoofer. Simply connect a single RCA subwoofer cable from the SUB OUT connection on the Speakers to the AUDIO INPUT on your subwoofer. If your subwoofer has a stereo L/R RCA input, either left or right inputs will work.

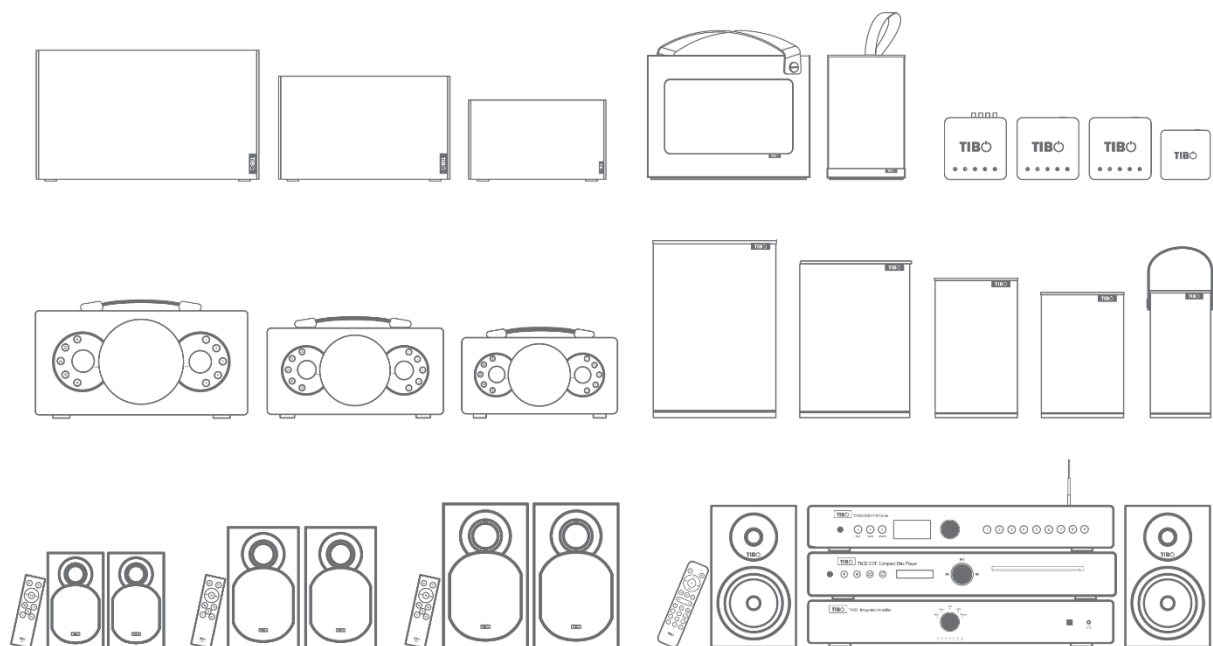

## 4. Bluetooth mode

- With your Bluetooth device and the TIBO Plus speakers system both turned ON, press the Mode button on the Plus speakers or the remote control to make the Plus speakers system enter Bluetooth mode. The speakers will reply saying “Bluetooth mode”.
- 
- The blue light will flash on the Plus speakers to show that Bluetooth mode is active, and the speakers are discoverable.
- 
- Set your Bluetooth device to discoverable so it can discover (refer to your Bluetooth device guide for details) TIBO Plus speakers system. Locate the Bluetooth device list in the user interface of your device.
- 
- From the Bluetooth device list, select the device named “TIBO Plus 2.1 or Plus 3.1” (depending on which model you have).
- 
- If your Bluetooth device prompts you for an access code, enter digits 0000 (four zeros) and press OK. Some devices also ask you to accept the connection. Your Bluetooth device indicates when pairing is complete.
- 
- The Plus speaker system indicates pairing is complete with welcome jingle.
-

## 5. Line In mode

- Whilst the Kameleon 4 / 6 is turned off, connect a 3.5mm jack cable to the 'Line in' port at the rear of the speaker and the other end of the cable to your Android/iOS device. This is to avoid speaker pop when the speaker is turned on.
- 
- Hold the power/mode button to turn on. If performed correctly, speaker will respond by saying "Power on." The speaker will then tell you what mode is currently activated. E.g. Wi-Fi mode.
- 
- Short press the mode button until the speaker responds saying "Line In mode." The mode light will also turn green.
- 
- You can now play music to the Kameleon speaker via your source, Spotify etc.
-

## 6. Troubleshooting

<b>Problem</b>	<b>Possible Cause</b>
No power	<ul style="list-style-type: none"><li>▪ AC power cord is not connected to the power supply or is not connected to a power supply correctly.</li></ul>
No sound or distorted	<ul style="list-style-type: none"><li>▪ The audio cables aren't connected correctly.</li><li>▪ The volume is set to the minimum level.</li><li>▪ The sound is switched OFF.</li></ul>
Plus speakers produce humming sound	<ul style="list-style-type: none"><li>▪ Signal lines from source device to Plus speakers are too long.</li><li>▪ Signal line used is not fault-protected or the protection has been damaged (defective).</li><li>▪ Ground loop (ripple pickup) generated.</li><li>▪ Another piece of equipment on the same circuit has no interference suppression (e.g. fridge).</li></ul>
The remote control does not function	<ul style="list-style-type: none"><li>▪ There is no battery in the remote control.</li><li>▪ The batteries are flat.</li><li>▪ The remote control isn't pointed to the remote sensor.</li><li>▪ The remote control is out of operating range.</li><li>▪ The unit is turned Off.</li></ul>
No playback via Bluetooth	<ul style="list-style-type: none"><li>▪ There is no connection between the Plus speakers and the Bluetooth end device.</li><li>▪ The Bluetooth end device is paired but no playback takes place.</li></ul>

## 7. Specifications

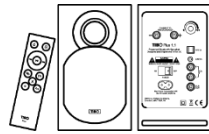

Product name	<b>Plus 1.1</b>
Power supply	AC 100-240V
Max output power	2 x 25W
Frequency response	20Hz – 20kHz
Impedance	4ohms
Bluetooth range	10 meters
Dimensions	105 x 172 x 135mm
Weight (kg)	1.4 (Active speaker) 1.1 (Passive speaker)
Sound resolution	24 bit/192kHz

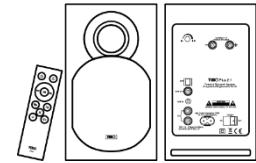

Product name	<b>Plus 2.1</b>
Power supply	AC 100-240V
Max output power	2 x 35W
Frequency response	20Hz – 20kHz
Impedance	4ohms
Bluetooth range	10 meters
Dimensions	130 x 223 x 185mm
Weight (kg)	2.5 (Active speaker) 2.0 (Passive speaker)
Sound resolution	24 bit/192kHz

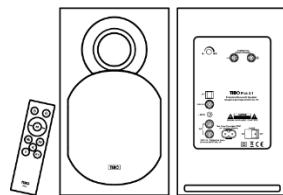

Product name	<b>Plus 3.1</b>
Power supply	AC 100-240V
Max output power	2 x 55W
Frequency response	20Hz – 20kHz
Impedance	4ohms
Bluetooth range	10 meters
Dimensions	165 x 265 x 205mm
Weight (kg)	3.3 (Active speaker) 2.9 (Passive speaker)
Sound resolution	24 bit/192kHz

The Bluetooth® word mark and logos are registered trademarks owned by Bluetooth SIG Inc. and any use of such marks by TIBO is under license. Other trademarks and trade names are those of their respective owners.